

Zoning Case: Z-2021-10700305
A request for a change from
MF-33 to C-1 with a Specific
Use Authorization for a
Medical - Clinic (Dentist)
at 1015 Shook Ave

01 SITE AREA CALCULATIONS

SCALE: 1/16"=1'

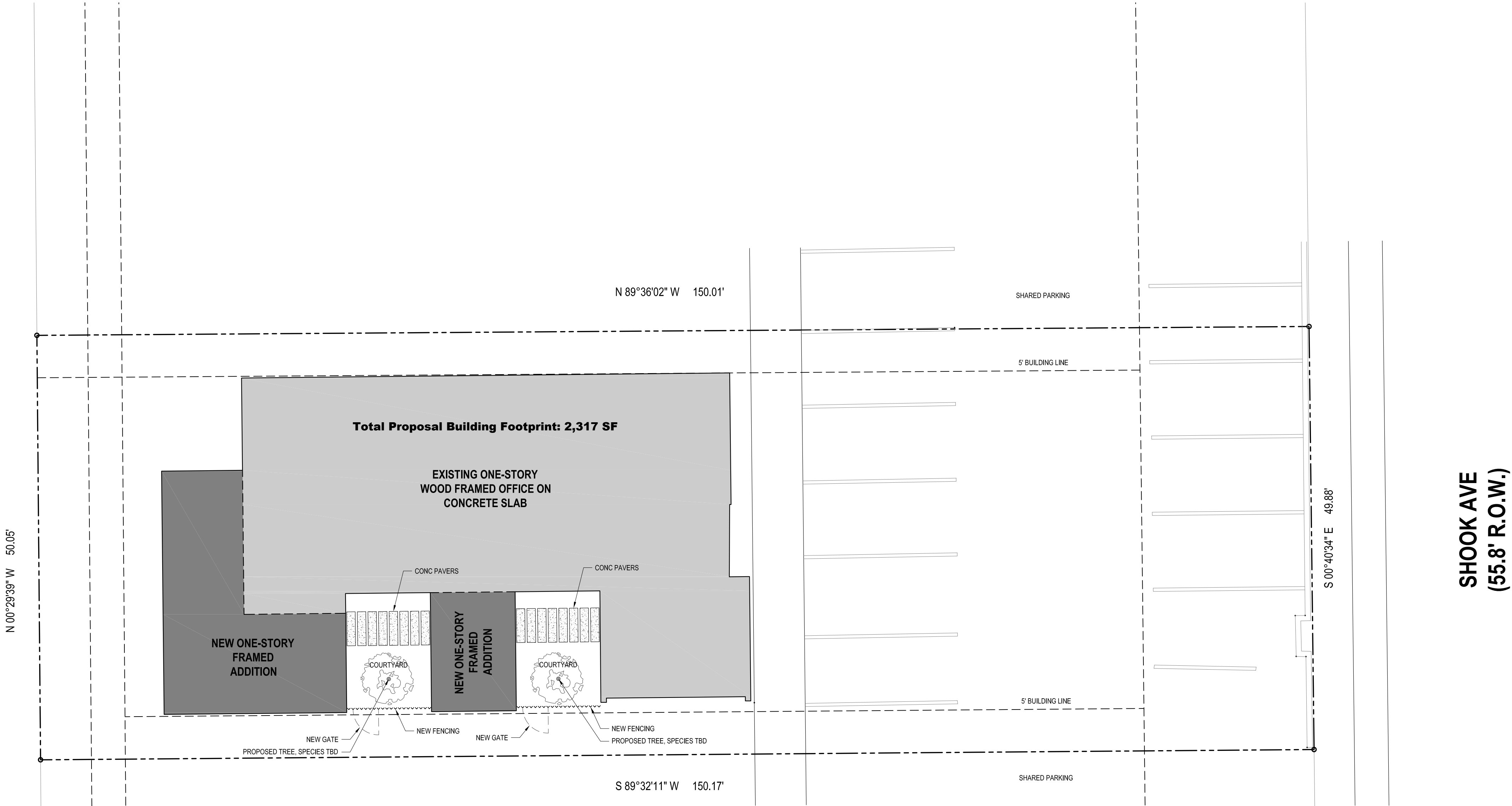

02 PROPOSED SITE PLAN

SCALE: 1/8"=1'

"I, Susannah Payne, the property owner, acknowledge that this site plan submitted for the purpose of rezoning this property is in accordance with all applicable provisions of the Unified Development Code. Additionally, I understand that City Council approval of a site plan in conjunction with a rezoning case does not relieve me from adherence to any/all City adopted Codes at the time of plan submittal for building permits."

© 2020 CONTENT LLC



REVISION	ISSUE	DATE
----------	-------	------

PAYNE DENTISTRY

1015 SHOOK AVE
SAN ANTONIO, TX 78212

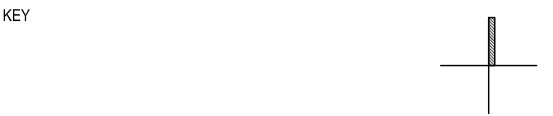

SCALE	VARIES
DATE	01 DECEMBER 2021
JOB#	21PYN

SCHEMATIC DESIGN
SITE AREA CALCULATIONS
PROPOSED SITE PLAN